

2.4G RF RGB+W LED FLOOD LIGHT (190W)

with 4-zone remote

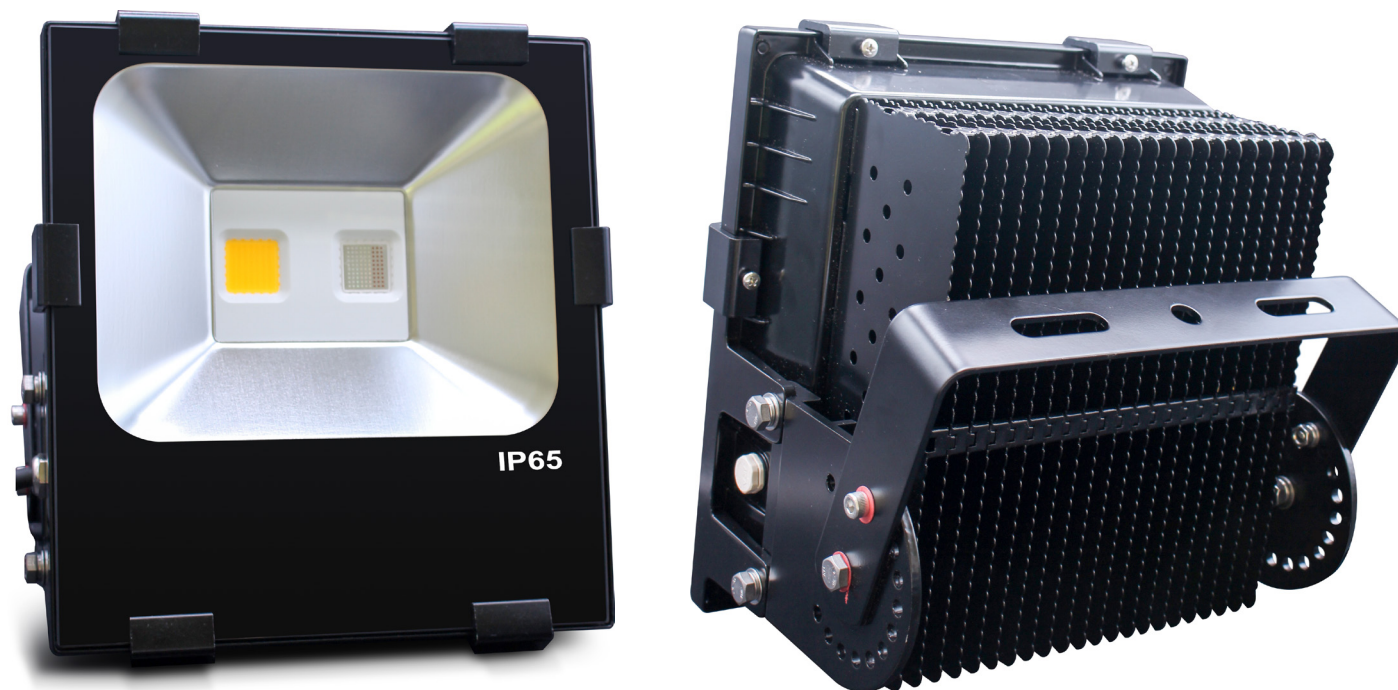

DIMENSIONS:

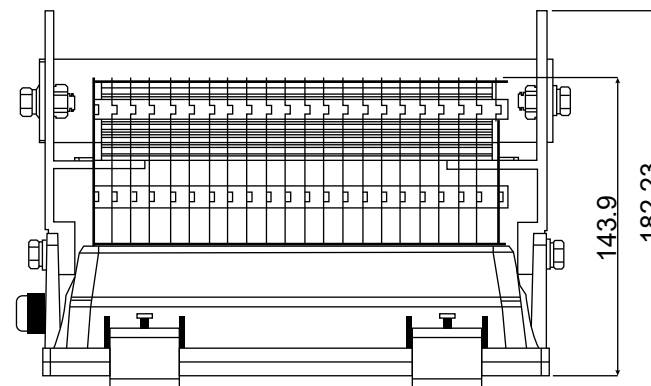
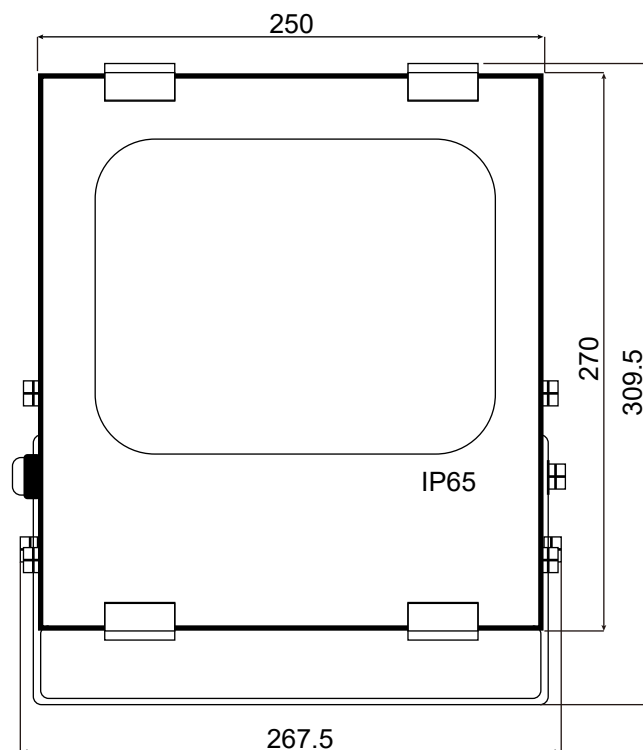

FEATURES:

1. **Power:** 90W RGB+100W warmwhite 2700K EPILEDs
2. **Remote range:** 30 meters
3. **Input voltage:** AC100-240V **Mean Well driver**
4. **material:** Aluminum, toughened glass
5. **LED color:** RGBW
6. **Working temp:** -20~60 degrees
7. **Life span:** 50,000h
8. **package:** 37(L)X35(W)X25(H)cm inner box 1pcs a carton
9. **Net weight:** 5000g
10. **Gross weight:** 6000g
11. Compatible with wifi bridge
12. Warm white 7000~7500lm (2700-3000K)
Red 1000-1200lm Green 2000-2200lm Blue 400-500lm



Materials & Process

1. Tempered glass panel to protect the lighting source, the transparent rate up to 93%.
2. 1060 aluminium heatsink with “zipped-fins” technology, optimized airflow duct inside the housing.
3. The entire housing coated by electrophoretic paint, excellent corrosion resistance.
4. Stainless steel screws and parts.

Innovation

Innovative cooling fins with light weight but massive cooling dissipation area, which tightly connected to the die-cast heatsink, constitute a integrated cooling housing.

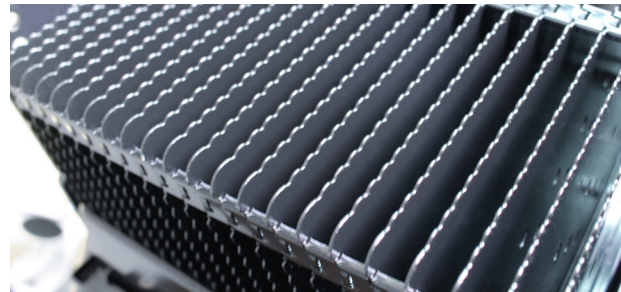

Patented zipped-fins technology

With zipped-fins technology, the convection airflow is evenly distributed in the cooling fins, optimizing the cooling effect.

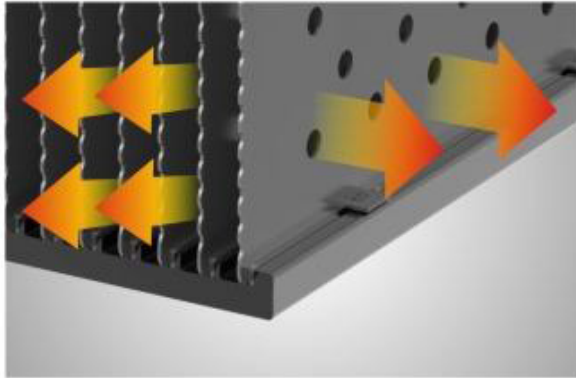

3-Dimension heat dissipation

There are convection holes distributed on each fins allowing parallel direction airflow to maximum the cooling power.

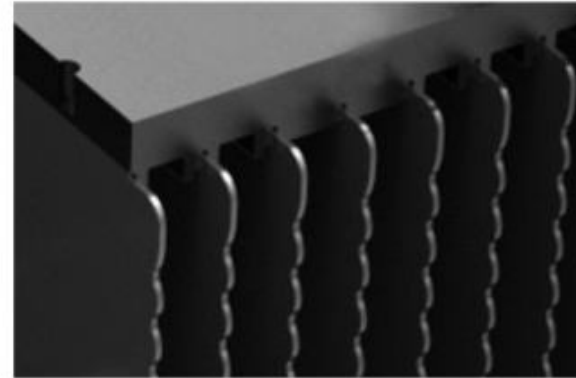

Gear slotting fin technology

The fins couple into the base of the heatsink tightly, minimum the heat transfer resistance.

Respirator design

Balance the different pressure between the atmosphere and the shell, it is water proof also defog and avoiding the drop condensation, reducing the inside salt corrosion and extend the product lifespan.

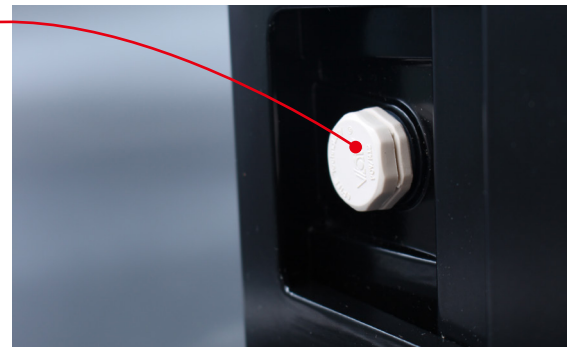

Excellent performance & Strong protection



Protection rate:IP65

By using watr-proof connector and silikonrubber sealing,the protection rate can achieve IP65, meeting the requirement forharsh, tough environment.



The entire housing coated by electrophoretic paint

Processed by electrophoretic paint, measured by 200hours salt test,the entire housing has excellent corrosion resistance.

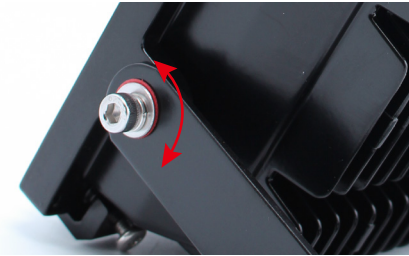

Wide angel for adjustment

Processed by electrophoretic paint, measured by 200hours salt test,the entire housing has excellent corrosion resistance.

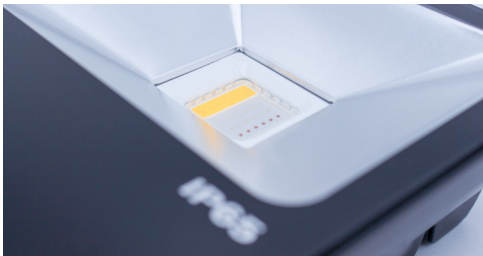

Pure aluminium reflector

The reflector is mede of pure aluminium(99.8%) which anti-oxidation and unfading in colour,ensuring the reflection.



Tempered glass panel

4mm tempered glass panel safely protect the lighting source,and the transparent rate is up to 93%.



Stainless steel parts

Endurancing the corrosion of air, chemiccal acid,alkaline,salt and other materials,can be used in all kinds of harsh conditions for long term.

INSTRUCTURE:

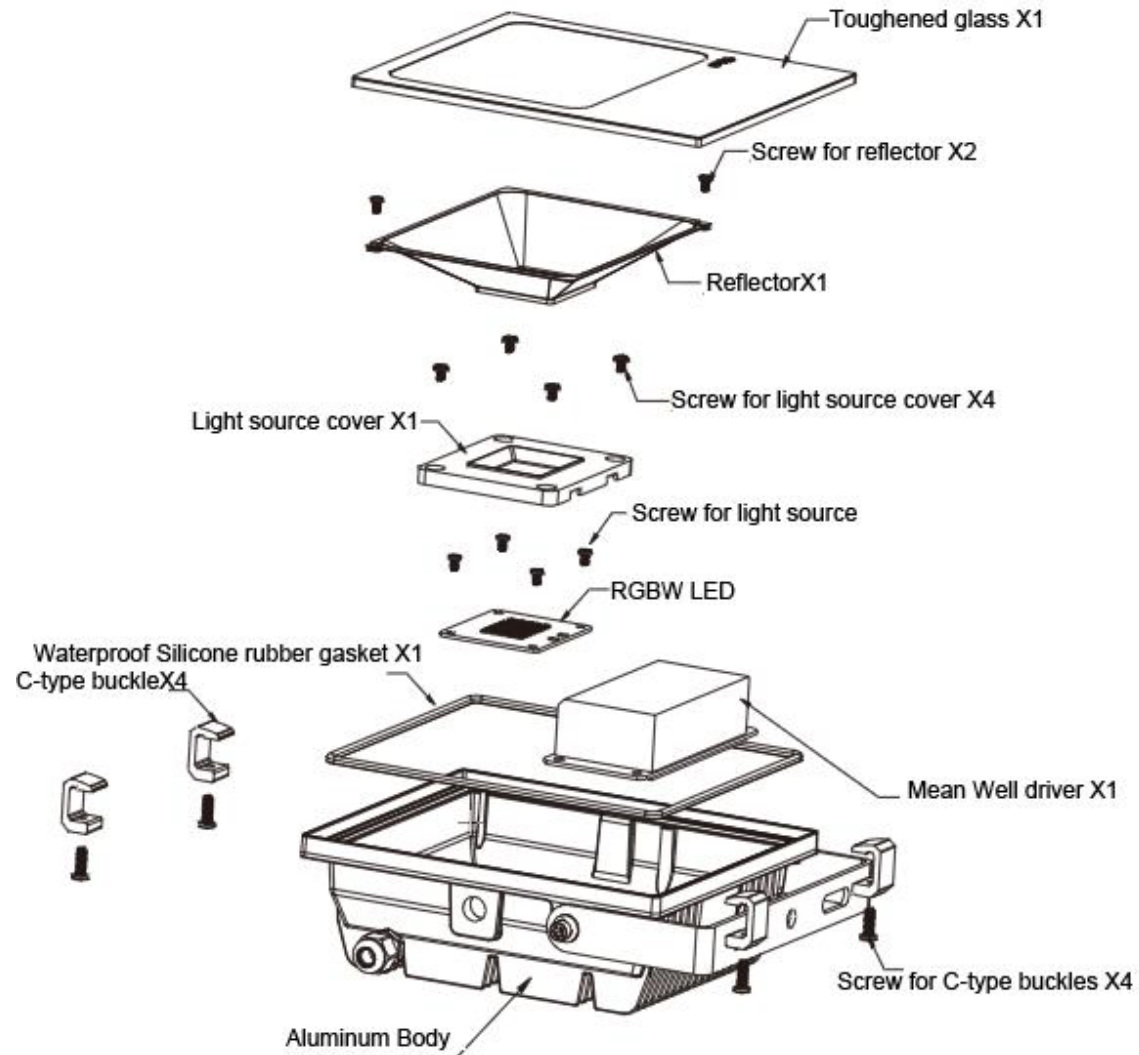

Application:

2.4G RGBW LED Flood lights are widely used in garden, villa, factory, gymnasium, boat yard, billboards, buildings, lawns, landscaping, offices, the site of light project and decorative lighting projects etc.



Package:

Inner box 37(L)X35(W)X25(H)

1pcs a carton

